



# SWINGING and SLIDING DOOR & WINDOW SYSTEMS

REBCO unveils their newest product, Metra swinging systems and sliding windows and doors which bring light and elegance to your environment.

Metra windows and doors adapt to any aesthetic design with comfort, energy-savings and security. Metra offers a wide choice of matching design accessories and a vast range of custom colors and finishes.

**Performance** – Metra entrances and windows ensure high thermal insulation performance, excellent acoustic insulation, water tightness, air tightness as well as resistance to saline corrosion and other harsh atmospheric agents.

## SWINGING SYSTEMS

### SWINGING NC 82 STH Entrances & Windows

#### Features

- 6063-T5 Aluminum Alloy Frame
- Frame Depth: 3.25"
- Accepts 1" Insulated Glass
- Weather Stripping: EPDM Gaskets
- Thermal Barrier: Polyamide
- Heavy Duty Hinges
- Multi-Point Lock System
- Durable Components

#### Applications

- Doors
- Fixed Windows
- Operable Windows

#### Benefits

- Acoustic Insulation
- Thermal Insulation
- Quiet and Smooth Closing System
- Easy Maintenance

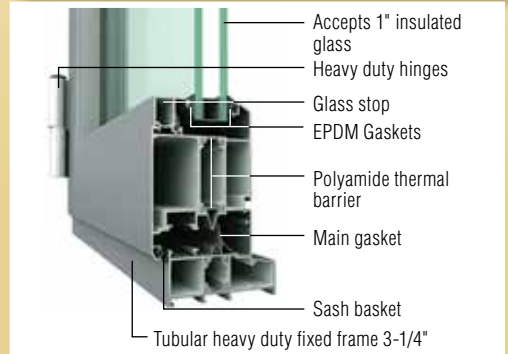

## SLIDING SYSTEMS

### SLIDING NC-S 120 SD Entrances & Windows

The sliding line is ideal for medium to large dimensions. Metra windows slide easily with their state-of-the-art opening and closing mechanisms.

#### Advantages

- Easy maintenance
- Thermal and acoustic insulation
- No architectural barriers
- Optimization of spaces
- High level design
- Inalterable and long-lasting
- Extremely smooth sliding action.

#### Features

- Air-water-wind tightness: Elaprene and brush gasket
- Slim line: brush gasket
- Accepts 1" Insulated Glass
- 6" Frame Depth
- Max. load each sash: 440.92 lb.
- Slim line: 881.84 lb.

#### Benefits

- Class CW-PG30-SD Size tested 96 x 84
- Positive design pressure (DP) = 30.0 psf
- Negative design pressure (DP) = -30.0 psf
- Water penetration resistance test pressure = 8.25 psf
- Canadian air infiltration / exfiltration level = A3 Level

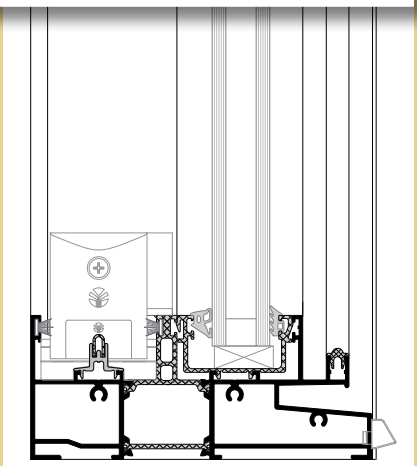



Rebco's in Front!!!



# SLIDING DOOR SYSTEMS

## NC-S 150 SD Sliding Door Systems

### NC-S 150 SD Lift and Slide Sliding Systems

Metra door systems can be set in any architectural environment, from new construction to retro-fit and historic restoration.

Metra's style and technological innovation set a high standard that benefits today's designers and architects.

#### Features

- 6063-T5 Aluminum Alloy Frame
- Frame Depth: 5.875"
- Accepts 1" Insulated Glass
- Max. Sash Weight: 660 lbs
- Weather Stripping: EPDM or Brush Gaskets
- Thermal Barrier: Polyamide
- Lift-and-Slide Mechanism
- Multi-point Lock System
- Durable Components

#### Benefits

- Large Unobstructed Openings
- Acoustic Insulation
- Thermal Insulation
- Quiet and Smooth Closing System
- Easy Maintenance

#### Applications

- Doors
- Windows Glazing Options

#### Lift and Slide Solution

- It's ideal for moving large, heavy sashes with ease.
- Controlled and silent movement of the sash.
- Bear loads up to 660 lbs.

#### Glazing Options

- The system provides design-flexibility to meet your performance needs. System will accommodate 1" Insulated Glass.
- Different configuration requirements can be evaluated.

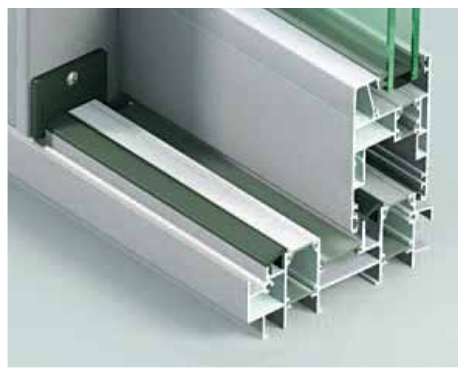

Lift & Slide Movement



Resting Position



Sliding Position

*Whatever your needs, from narrow stile to FRP doors or entrances – hopper, vent, casement and fixed windows – sliding and double hung windows – storefront systems – sheets or panels – angles, bars – channels or stock lengths, REBCO offers the products you need to meet your specifications.*

*REBCO stocks the largest selection of architectural aluminum shapes in the New York Metropolitan area, and serves the glass industry from coast to coast!*

**REBCO, INCORPORATED**  
1171-1225 Madison Ave., P.O. Box 2248  
Paterson, New Jersey 07509-2248

Outside NY/NJ: 800-777-0787  
NJ: 973-684-0200  
NY: 212-736-6435  
FAX: 973-684-0118  
WEB: [www.rebcoinc.com](http://www.rebcoinc.com)

Made in U.S.A. © 12/2015, REBCO, INC.  
Design by L.E. Designers, Inc.

Call REBCO today at 800-777-0787  
for more information or visit

[www.rebcoinc.com](http://www.rebcoinc.com)