



Rebco's in Front!!!

Architectural Windows





Series 2000 THERMA-BARRIER & NON THERMAL Projected & Casement Windows



REBCO THERMA-BARRIER Windows combine superior construction for durability and ease of operation . . . with the energy economy and all-weather comfort of the Therma-Barrier thermal barrier system.

Special thermal insulation in extruded aluminum perimeters and mullions creates a defensive barrier against heat flow, and when combined with insulating glass, there is a marked reduction in condensation on both glazing frames.

REBCO THERMA-BARRIER Windows feature:

- Exclusive use of 4-Bar Hinges.
- 3/8" Heavy Duty Corner Keys on sash.
- Snap on glazing beads for 1/4", 5/8" or 1 Glazing.
- Polyurethane thermal barrier.
- Superior White Bronze Hardware.
- Double Weather-stripping between sash and frame.
- Mitred Corners on sashes.

REBCO THERMA-BARRIER Windows are available in bronze hardcoat, clear anodized and white painted finishes to give you an ideal combination of styling, energy savings and maximum comfort.

Specifications *Rated AP-HC40 60 x 100 rating. Test results available.**

GENERAL – Furnish and install REBCO Series 2000 insulated aluminum windows as manufactured by REBCO Incorporated, Paterson, NJ. The windows shall include the necessary hardware and related items as described in this section and as detailed on the plans.

SHOP DRAWINGS – Complete shop drawings showing window elevations, plan drawing, and full size sections are available upon request.

MATERIALS – The windows shall be fabricated from extruded aluminum alloy 6063-T5. All members shall be a minimum 2" in depth. All sash sections shall be tubular extrusions with a minimum 1/8" in combined wall sections. Glazing beads shall have a thickness of not less than .045". Window sections shall have a minimum glazing leg .70" and they shall be provided with snap-on aluminum glazing beads.

CONSTRUCTION – Frame corners shall be machine cut for precision fit and butt jointed and mechanically fastened using stainless steel fasteners. Sash corners shall be mitred and mechanically crimped and epoxy glued under several tons of pneumatic force. Muntin bars shall be coped to create a mortised joint which shall be argon-electric welded to insure maximum strength.

WEATHER-STRIP – The operating vent shall be double weather-stripped with Q-Lon. The weather-strip shall be uninterrupted and secured within extruded raceways at the interior and exterior points of contact with the surrounding frame.

HARDWARE – Projected windows shall be provided with two 4-bar hinge assemblies securely fastened to the frame and vent, and operating in a track provided with an adjustable nylon friction feature. The cam handles shall be manufactured from white bronze and secured with stainless steel fasteners. Casement windows shall be supported by butt hinges manufactured from white bronze and secured with stainless fasteners. Casements shall have white bronze locking handles with concealed strikes. Locking handles and concealed strikes shall be securely fastened with stainless steel fasteners.

FINISH – The finished units shall be supplied by the window manufacturer. The finish shall be (REBCO Series 2000 windows are available in Clear Anodized Acid Etch, Dark Bronze Acid Etch, and White Hi-Solid Polyester electrostatically applied paint). Custom colors available on Therma-Barrier for larger orders and in smaller or larger quantities on non-thermal units.

THERMAL BARRIER – The thermal barrier shall consist of a two-part, chemically-curing, high strength, pure polyurethane casting resin. This thermal barrier shall provide a continuous uninterrupted break around the entire perimeter of the frame and vent and it shall not be abridged by any metals, conductors or other similar materials. The cavity size of the thermal break shall be .437" wide, .350" high and shall have a throat opening of at least .188" wide. Residential size cavities will not be permitted.

INSTALLATION – Windows shall be installed by experienced window erectors, in accordance with REBCO approved shop drawings. All members shall be set plumb and level with ventilators in true alignment. All aluminum surfaces in contact with masonry or steel shall be insulated therefrom by pressure sensitive tape, zinc chromate primer, lacquer or bituminous paint.

PROTECTION AND CLEANING: The purchaser shall protect the aluminum entrance, window and/or frame material and finish against damage from construction activities and harmful substances. Upon completion of construction, the purchaser and/or general contractor shall be responsible for cleaning the aluminum with plain water containing mild soap or detergent or a petroleum product such as white gasoline, kerosene, or distillate. No abrasive agent shall be used.

**TEST SPECIFICATION – The test specimen was evaluated in accordance with AAMA/NWWDA 101/I.S.2-97, Voluntary Specifications for Aluminum, Vinyl (PVC) and Wood Windows and Glass Doors.*

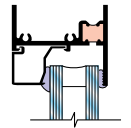

SECTION 1-1

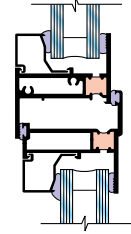

SECTION 1-2

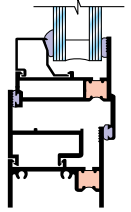

SECTION 1-3

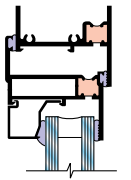

SECTION 2-1

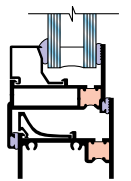

SECTION 2-2

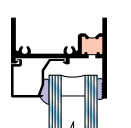

SECTION 3-1

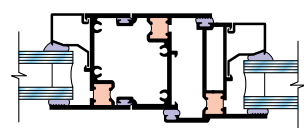

SECTION 3-2

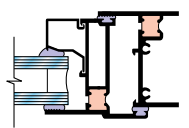

SECTION 3-3

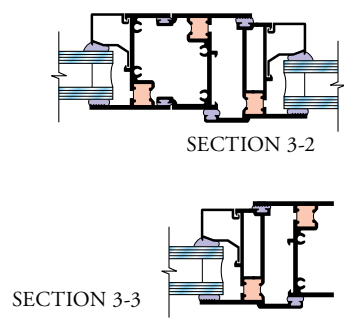
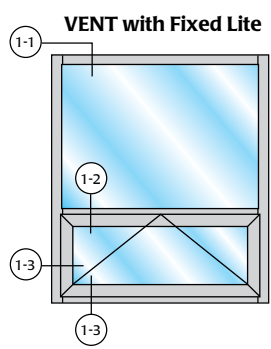
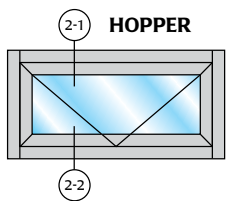
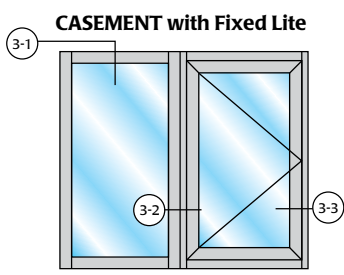

Series 25000 THERMA-BARRIER Projected & Casement Windows

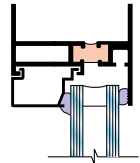

SECTION 4-1

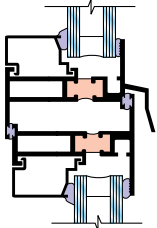

SECTION 4-2

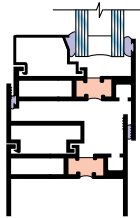

SECTION 4-3

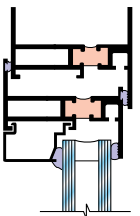

SECTION 5-1

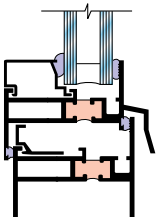

SECTION 5-2

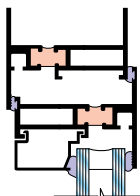

SECTION 6-1

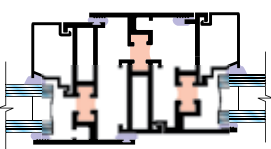

SECTION 6-2

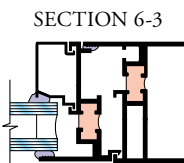

SECTION 6-3

REBCO THERMA-BARRIER Windows combine superior construction for durability and ease of operation . . . with the energy economy and all-weather comfort of the Therma-Barrier thermal barrier system.

Special thermal insulation in extruded aluminum perimeters and mullions creates a defensive barrier against heat flow, and when combined with insulating glass, there is a marked reduction in condensation on both glazing frames.

REBCO THERMA-BARRIER Windows feature:

- Exclusive use of 4-Bar Hinges.
- 3/8" Heavy Duty Corner Keys on Frame, 3/16" on sash.
- Mitred Corners.
- Snap on glazing beads for 5/8" or 1 Glazing.
- All Tubular Sections.
- Double Weather-stripping between sash and frame.
- Superior White Bronze Hardware.
- Polyurethane thermal barrier.

REBCO THERMA-BARRIER Windows are available in dark bronze hardcoat, clear anodized and white painted finishes to give you an ideal combination of styling, energy savings and maximum comfort.

Specifications *Rated AP-HC80 60 x 100 rating. Test results available.**

GENERAL – Furnish and install REBCO Series 25000 insulated aluminum windows as manufactured by REBCO Incorporated, Paterson, NJ. The windows shall include the necessary hardware and related items as described in this section and as detailed on the plans.

SHOP DRAWINGS – Complete shop drawings showing window elevations, plan drawing, and full size sections are available upon request.

MATERIALS – The windows shall be fabricated from extruded aluminum alloy 6063-T5. All members shall be a minimum 2-1/2" in depth. All frame and vent sections shall be tubular extrusions with a minimum 3/16" in combined wall sections. Glazing beads shall have a thickness of not less than .045". Window sections shall have a minimum glazing leg 3/4" and they shall be provided with snap-on aluminum glazing beads.

CONSTRUCTION – Frame corners shall be machine cut for precision fit and butt jointed and mechanically fastened using stainless steel fasteners. Sash corners shall be mitred and mechanically crimped and epoxy glued under several tons of pneumatic force. Muntin bars shall be coped to create a mortised joint which shall be argon-electric welded to insure maximum strength.

WEATHER-STRIP – The operating vent shall be double weather-stripped with a Q-Lon. The weather-strip shall be uninterrupted and secured within extruded raceways at the interior and exterior points of contact with the surrounding frame.

HARDWARE – Projected windows shall be provided with two 4-bar hinge concealed assemblies securely fastened to the frame and vent, and operating in a track provided with an adjustable nylon friction feature. The cam handles shall be manufactured from white bronze and secured with stainless steel fasteners. Casement windows shall be supported by butt hinges manufactured from white bronze and secured with stainless steel fasteners. Casements shall have white bronze locking handles with concealed strikes. Locking handles and concealed strikes shall be securely fastened with stainless steel fasteners.

FINISH – The finished units shall be supplied by the window manufacturer. The finish shall be _____ (REBCO Series 25000 windows are available in Clear Anodized Acid Etch, Dark Bronze Acid Etch, and White Hi-Solid Polyester electrostatically applied paint). Custom colors available on large orders.

THERMAL BARRIER – The thermal barrier shall consist of a two-part, chemically-curing, high strength, pure polyurethane casting resin. This thermal barrier shall provide a continuous uninterrupted break around the entire perimeter of the frame and vent and it shall not be abridged by any metals, conductors or other similar materials. The cavity size of the thermal break shall be .744" wide, .350" high and shall have a throat opening of at least .312" wide. Residential size cavities will not be permitted.

INSTALLATION – Windows shall be installed by experienced window erectors, in accordance with REBCO approved shop drawings. All members shall be set plumb and level with ventilators in true alignment. All aluminum surfaces in contact with masonry or steel shall be insulated therefrom by pressure sensitive tape, zinc chromate primer, lacquer or bituminous paint.

PROTECTION AND CLEANING – Upon completion of erection, windows will be left in a clean condition. Protection against damage by others and finish cleaning shall be the responsibility of the general contractor.

Many other combinations of operable and fixed windows are available. Dark Bronze and Clear Anodized and also White and Brown Baked Electrostatic Enamel extrusions are stocked for prompt delivery.

**TEST SPECIFICATION – The test specimen was evaluated in accordance with AAMA/NWWDA 101/I.S.2-97, Voluntary Specifications for Aluminum, Vinyl (PVC) and Wood Windows and Glass Doors.*

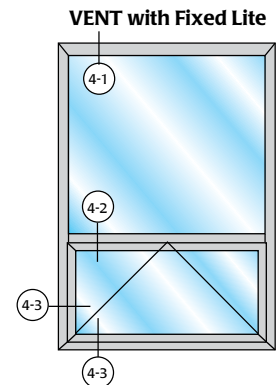
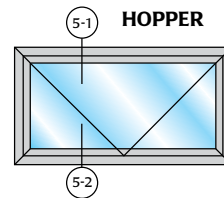
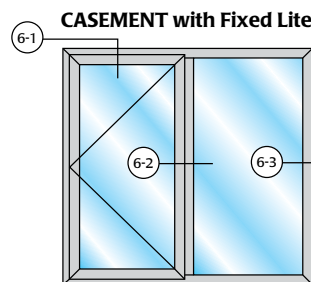

REBCO Installations, Windows and more . . .

If you are considering new construction or retro-fitting an existing building, **REBCO** products are an ideal solution. Our factory is well equipped to handle custom projects, matching specific colors, sizes and other specifications, right down to custom hardware for a vintage or a contemporary look. Our in-house craftsmen pay close attention to each detail, assuring your materials will arrive at the job site exactly as ordered and in your time table.

REBCO windows meet and exceed tough industry standards and are rated at AP-HC40 60 x 100 for our 2000 Series window, and our 25000 Series window achieved an AP-HC80 60 x 100 rating. Our commercial windows, custom and standard entrances and storefront systems can be seen throughout the northeast and mid-Atlantic in prestigious projects like the *U. S. Military Academy, West Point, NY* (left); *New York University, New York, NY*; *State University of New York, Binghamton, NY*; *Rutgers University Library, New Brunswick, New Jersey* & *Princeton University, Princeton, NJ*.

REBCO products can also be seen in projects as diverse as the *Statue of Liberty, New York Harbor*; *LaGuardia Airport, Queens, NY*; *I.B.M. Poughkeepsie, NY*; *General Electric, Allentown, PA*; *Merrill Lynch, Lakewood, NJ*; *U. S. Naval Base, Philadelphia, PA*; *Port Authority Bus Terminal, New York, NY*; *Police Headquarters, New York, NY*; *Pennock Library, Pennock, Michigan*; *The Good Samaritan Hospital, Baltimore, Maryland*; *Newark Main Post Office, Newark, NJ*; *New York Public Library, NY, NY*; *Squadron Operations, Andrews Air Force Base, Washington, DC*; *Kentucky Fried Chicken and Dunkin' Donuts Stores throughout NY and NJ*.



Other fine REBCO products

Whatever your needs, from casement and fixed windows to hoppers and vents – standard and custom designer entrances – narrow to wide stile to FRP doors – sliding and end-fold entrances – storefront systems – sheets and panels – angles, bars, channels and stock lengths, **REBCO** offers the products you need to meet your specifications.



REBCO stocks the largest selection of architectural aluminum shapes in the New York Metropolitan area, and serves the glass industry from coast to coast!

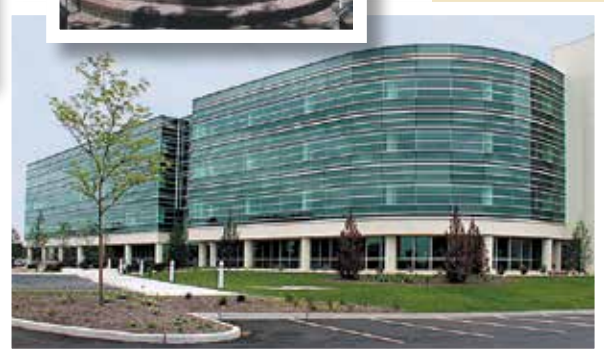

Rebco's in Front!!!

1171-1225 Madison Ave., P.O. Box 2248
Paterson, New Jersey 07509-2248
Outside NY/NJ: 800-777-0787

NJ: 973-684-0200
NY: 212-736-6435
FAX: 973-684-0118
WEB: www.REBCOinc.com

REBCO
INCORPORATED

Made in U.S.A. © 6/2012, REBCO, INC.
Design by L.E. Designers, Inc.